

PUNTE PER FORATRICE

Router Bits



7

PUNTE PER CERNIERE
Hinge Boring Bits

Page
129



PUNTE PER FORATRICI CIECHE
Blind Holes Boring Bits

130



PUNTE PER FORATRICI PASSANTI
Through Holes Boring Bits

131



7 PUNTE PER FORATRICE Boring Bits

LAVORAZIONE

Application

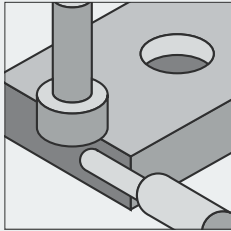

Forare cieco
Blind holes

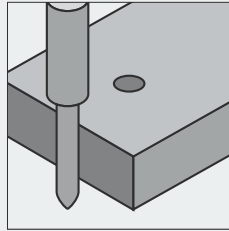

Forare passante
Through holes



PUNTE PER CERNIERE

Hinge Boring Bits

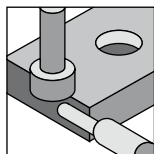

Ideali nella foratura cieca dei pannelli in Truciolare e MDF grezzi o nobilitati e multistrati su macchine foratrici, Punto punto e centri di lavoro CNC orizzontali o verticali.

Ottima finitura senza scheggiature.

Estrema precisione del foro.

Taglio frazionato per una migliore penetrazione.

Piolino centrale ad altezza ridotta.

Attacco D10 componibile con pianetto.

Capacità di 6/8 riaffilature.

Used on boring machines and CNC routers for chipboard, MDF, HDF and sandwich panels with or without veneer.

Excellent finish both on panel and coating, without chipping.

Tight tolerances on bore diameter.

Split cut for smoother plunging.

Centering pin with reduced height.

Ø10 mm shank with flat side.

Average 6-8 resharpening.

| CODE RH | CODE LH | D | L1 | d | L2 | L3 | Z |
|---------|---------|------|------|----|----|------|-----|
| 3201512 | 3201513 | 14 | 32,5 | 10 | 25 | 57,5 | 2+2 |
| 3201516 | 3201517 | 15 | 32,5 | 10 | 25 | 57,5 | 2+2 |
| 3201520 | 3201521 | 16 | 32,5 | 10 | 25 | 57,5 | 2+2 |
| 3201524 | 3201525 | 18 | 32,5 | 10 | 25 | 57,5 | 2+2 |
| 3201528 | 3201529 | 20 | 32,5 | 10 | 25 | 57,5 | 2+2 |
| 3201532 | 3201533 | 22 | 32,5 | 10 | 25 | 57,5 | 2+2 |
| 3201536 | 3201537 | 24 | 32,5 | 10 | 25 | 57,5 | 2+2 |
| 3201540 | 3201541 | 25 | 32,5 | 10 | 25 | 57,5 | 2+2 |
| 3201544 | 3201545 | 26 | 32,5 | 10 | 25 | 57,5 | 2+2 |
| 3201548 | 3201549 | 28 | 32,5 | 10 | 25 | 57,5 | 2+2 |
| 3201552 | 3201553 | 30 | 32,5 | 10 | 25 | 57,5 | 2+2 |
| 3201556 | 3201557 | 35 | 32,5 | 10 | 25 | 57,5 | 2+2 |
| 3201560 | 3201561 | 35,2 | 32,5 | 10 | 25 | 57,5 | 2+2 |
| 3201564 | 3201565 | 35,5 | 32,5 | 10 | 25 | 57,5 | 2+2 |
| 3201568 | 3201569 | 40 | 32,5 | 10 | 25 | 57,5 | 2+2 |
| 3201572 | 3201573 | 45 | 32,5 | 10 | 25 | 57,5 | 2+2 |
| 3201576 | 3201577 | 50 | 32,5 | 10 | 25 | 57,5 | 2+2 |
| 3201580 | 3201581 | 55 | 32,5 | 10 | 25 | 57,5 | 2+2 |
| 3201712 | 3201713 | 14 | 45 | 10 | 25 | 70 | 2+2 |
| 3201716 | 3201717 | 15 | 45 | 10 | 25 | 70 | 2+2 |
| 3201720 | 3201721 | 16 | 45 | 10 | 25 | 70 | 2+2 |
| 3201724 | 3201725 | 18 | 45 | 10 | 25 | 70 | 2+2 |
| 3201728 | 3201729 | 20 | 45 | 10 | 25 | 70 | 2+2 |
| 3201732 | 3201733 | 22 | 45 | 10 | 25 | 70 | 2+2 |
| 3201736 | 3201737 | 24 | 45 | 10 | 25 | 70 | 2+2 |
| 3201740 | 3201741 | 25 | 45 | 10 | 25 | 70 | 2+2 |
| 3201744 | 3201745 | 26 | 45 | 10 | 25 | 70 | 2+2 |
| 3201748 | 3201749 | 28 | 45 | 10 | 25 | 70 | 2+2 |
| 3201752 | 3201753 | 30 | 45 | 10 | 25 | 70 | 2+2 |
| 3201756 | 3201757 | 35 | 45 | 10 | 25 | 70 | 2+2 |
| 3201760 | 3201761 | 35,2 | 45 | 10 | 25 | 70 | 2+2 |
| 3201764 | 3201765 | 35,5 | 45 | 10 | 25 | 70 | 2+2 |
| 3201768 | 3201769 | 40 | 45 | 10 | 25 | 70 | 2+2 |
| 3201772 | 3201773 | 45 | 45 | 10 | 25 | 70 | 3+3 |
| 3201776 | 3201777 | 50 | 45 | 10 | 25 | 70 | 3+3 |
| 3201780 | 3201781 | 55 | 45 | 10 | 25 | 70 | 3+3 |

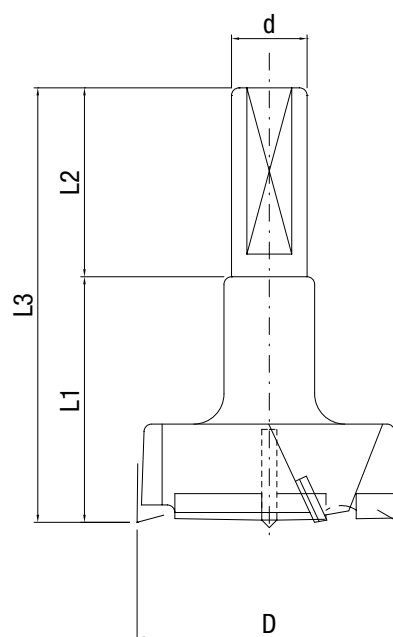

PUNTE PER FORATRICE CIECHE

Blind Holes Boring Bits

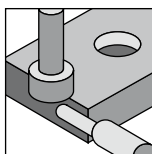

Ideali nella foratura cieca dei pannelli in Truciolare e MDF grezzi o nobilitati e multistrati su macchine foratrici, Punto punto e centri di lavoro CNC orizzontali o verticali.
Ottima finitura senza scheggiature.
Estrema precisione del foro.
Attacco D10 componibile con pianetto.
Capacità di 1-3 riaffilature.

Used on boring machines and CNC routers for chipboard, MDF, HDF and sandwich panels with or without veneer, plywood.
Excellent finish both on panel and coating, without chipping.
Tight tolerances on bore diameter.
Ø10 mm shank with flat side.
Average 1-3 resharpening.



| CODE RH | CODE LH | D | L1 | d | L2 | L3 | Z |
|---------|---------|------|------|----|----|------|---|
| 3001012 | 3001013 | 5 | 32,5 | 10 | 25 | 57,5 | 2 |
| 3001016 | 3001017 | 5,5 | 32,5 | 10 | 25 | 57,5 | 2 |
| 3001020 | 3001021 | 6 | 32,5 | 10 | 25 | 57,5 | 2 |
| 3001024 | 3001025 | 6,5 | 32,5 | 10 | 25 | 57,5 | 2 |
| 3001028 | 3001029 | 7 | 32,5 | 10 | 25 | 57,5 | 2 |
| 3001032 | 3001033 | 7,5 | 32,5 | 10 | 25 | 57,5 | 2 |
| 3001028 | 3001029 | 8 | 32,5 | 10 | 25 | 57,5 | 2 |
| 3001032 | 3001033 | 8,5 | 32,5 | 10 | 25 | 57,5 | 2 |
| 3001036 | 3001037 | 10 | 32,5 | 10 | 25 | 57,5 | 2 |
| 3001040 | 3001041 | 10,5 | 32,5 | 10 | 25 | 57,5 | 2 |
| 3001044 | 3001045 | 11 | 32,5 | 10 | 25 | 57,5 | 2 |
| 3001048 | 3001049 | 12 | 32,5 | 10 | 25 | 57,5 | 2 |
| 3001052 | 3001053 | 13 | 32,5 | 10 | 25 | 57,5 | 2 |
| 3001112 | 3001113 | 5 | 45 | 10 | 25 | 70 | 2 |
| 3001116 | 3001117 | 5,5 | 45 | 10 | 25 | 70 | 2 |
| 3001120 | 3001121 | 6 | 45 | 10 | 25 | 70 | 2 |
| 3001124 | 3001125 | 6,5 | 45 | 10 | 25 | 70 | 2 |
| 3001128 | 3001129 | 7 | 45 | 10 | 25 | 70 | 2 |
| 3001132 | 3001133 | 7,5 | 45 | 10 | 25 | 70 | 2 |
| 3001128 | 3001129 | 8 | 45 | 10 | 25 | 70 | 2 |
| 3001132 | 3001133 | 8,5 | 45 | 10 | 25 | 70 | 2 |
| 3001136 | 3001137 | 10 | 45 | 10 | 25 | 70 | 2 |
| 3001140 | 3001141 | 10,5 | 45 | 10 | 25 | 70 | 2 |
| 3001144 | 3001145 | 11 | 45 | 10 | 25 | 70 | 2 |
| 3001148 | 3001149 | 12 | 45 | 10 | 25 | 70 | 2 |
| 3001152 | 3001153 | 13 | 45 | 10 | 25 | 70 | 2 |

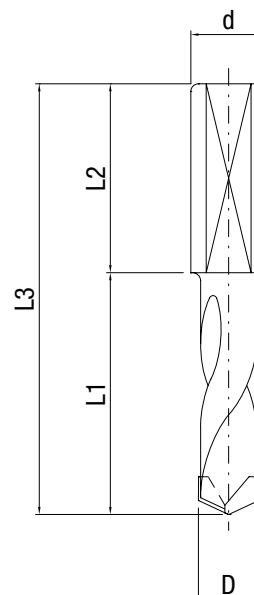

PUNTE PER FORATRICI PASSANTI

Through Holes Boring Bits

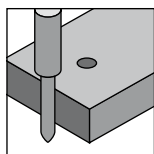

Ideali nella foratura passante dei pannelli in Truciolare e MDF grezzi o nobilitati e multistrati su macchine foratrici, Punto punto e centri di lavoro CNC orizzontali o verticali.
Ottima finitura senza scheggiature.
Estrema precisione del foro.
Attacco D10 componibile con pianetto.
Capacità di 1-3 riaffilature.

Used on boring machines and CNC routers for chipboard, MDF, HDF and sandwich panels with or without veneer, plywood.
Excellent finish both on panel and coating, without chipping.
Tight tolerances on bore diameter.
Ø10 mm shank with flat side.
Average 1-3 resharpening.



| CODE RH | CODE LH | D | L1 | d | L2 | L3 | Z |
|---------|---------|------|------|----|----|------|---|
| 3101012 | 3101013 | 5 | 32,5 | 10 | 25 | 57,5 | 2 |
| 3101016 | 3101017 | 5,5 | 32,5 | 10 | 25 | 57,5 | 2 |
| 3101020 | 3101021 | 6 | 32,5 | 10 | 25 | 57,5 | 2 |
| 3101024 | 3101025 | 6,5 | 32,5 | 10 | 25 | 57,5 | 2 |
| 3101028 | 3101029 | 7 | 32,5 | 10 | 25 | 57,5 | 2 |
| 3101032 | 3101033 | 7,5 | 32,5 | 10 | 25 | 57,5 | 2 |
| 3101028 | 3101029 | 8 | 32,5 | 10 | 25 | 57,5 | 2 |
| 3101032 | 3101033 | 8,5 | 32,5 | 10 | 25 | 57,5 | 2 |
| 3101036 | 3101037 | 10 | 32,5 | 10 | 25 | 57,5 | 2 |
| 3101040 | 3101041 | 10,5 | 32,5 | 10 | 25 | 57,5 | 2 |
| 3101044 | 3101045 | 11 | 32,5 | 10 | 25 | 57,5 | 2 |
| 3101048 | 3101049 | 12 | 32,5 | 10 | 25 | 57,5 | 2 |
| 3101052 | 3101053 | 13 | 32,5 | 10 | 25 | 57,5 | 2 |
| 3101112 | 3101113 | 5 | 45 | 10 | 25 | 70 | 2 |
| 3101116 | 3101117 | 5,5 | 45 | 10 | 25 | 70 | 2 |
| 3101120 | 3101121 | 6 | 45 | 10 | 25 | 70 | 2 |
| 3101124 | 3101125 | 6,5 | 45 | 10 | 25 | 70 | 2 |
| 3101128 | 3101129 | 7 | 45 | 10 | 25 | 70 | 2 |
| 3101132 | 3101133 | 7,5 | 45 | 10 | 25 | 70 | 2 |
| 3101128 | 3101129 | 8 | 45 | 10 | 25 | 70 | 2 |
| 3101132 | 3101133 | 8,5 | 45 | 10 | 25 | 70 | 2 |
| 3101136 | 3101137 | 10 | 45 | 10 | 25 | 70 | 2 |
| 3101140 | 3101141 | 10,5 | 45 | 10 | 25 | 70 | 2 |
| 3101144 | 3101145 | 11 | 45 | 10 | 25 | 70 | 2 |
| 3101148 | 3101149 | 12 | 45 | 10 | 25 | 70 | 2 |
| 3101152 | 3101153 | 13 | 45 | 10 | 25 | 70 | 2 |

